

Install and Operation

Instructions

RD200-LF, RD200-M1, RD200-MIC
V01.10

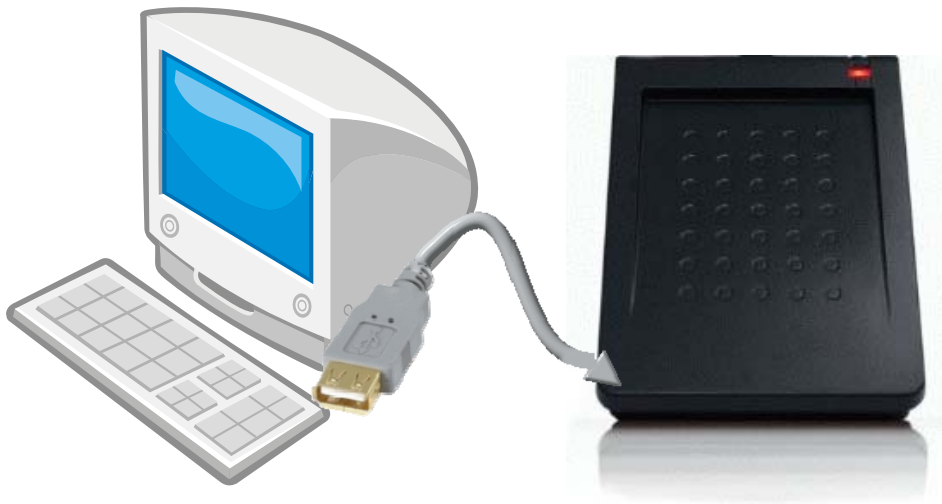

Specifications :

Type	RD200-LF	RD200-M1	RD200-MIC
Frequency	125KHz / 134.2KHz	13.56MHz	13.56MHz
Tag Supported	EM4100 compatible class / SYRIS / FDX-B(ISO11784)	ISO-14443A (Mifare/ Ultralight Mifare)	ISO-15693 ISO-14443A/B (Mifare/ Ultralight Mifare)
Reading Range	0~6 cm	0~7.5cm	
Communication Interface	USB 1.1/2.0 Compatible, USB Mini 5-pin connector		
Antenna	Build-in Antenna		
Indicator	Two-color LED visual indication and Buzzer		
Operating / Storage Temp.	-20~70℃ / -30~80 ℃		
Power Supply and current consumption	Power supply through USB, 5V / 200mA		
Dimension(W x L x H)	105x72x16mm		

Install and Operation

Instructions

RD200-LF, RD200-M1, RD200-MIC
V01.10

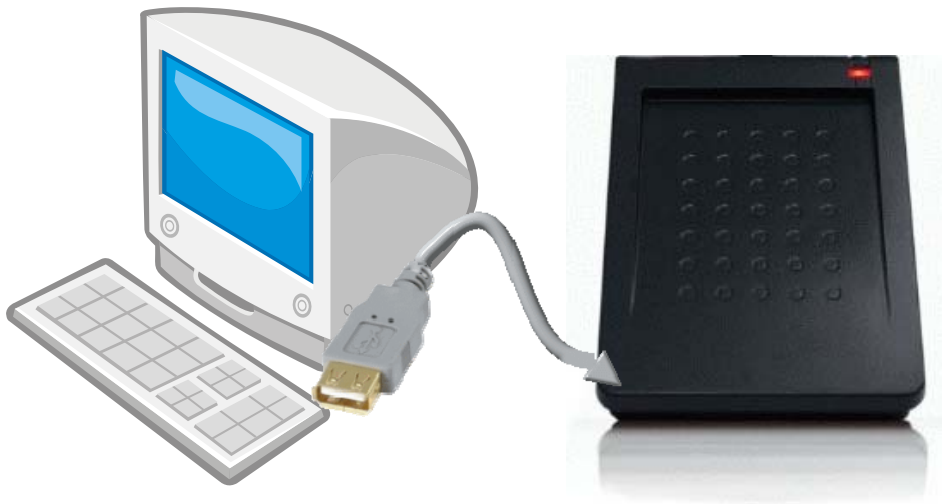

Specifications :

Type	RD200-LF	RD200-M1	RD200-MIC
Frequency	125KHz / 134.2KHz	13.56MHz	13.56MHz
Tag Supported	EM4100 compatible class / SYRIS / FDX-B(ISO11784)	ISO-14443A (Mifare/ Ultralight Mifare)	ISO-15693 ISO-14443A/B (Mifare/ Ultralight Mifare)
Reading Range	0~6 cm	0~7.5cm	
Communication Interface	USB 1.1/2.0 Compatible, USB Mini 5-pin connector		
Antenna	Build-in Antenna		
Indicator	Two-color LED visual indication and Buzzer		
Operating / Storage Temp.	-20~70℃ / -30~80 ℃		
Power Supply and current consumption	Power supply through USB, 5V / 200mA		
Dimension(W x L x H)	105x72x16mm		